

# KUGELHÄHNE - MESSING VERNICKELT

## Ball valve - brass nickel plated

### Mini - Kugelhahn

#### Mini ball-valve

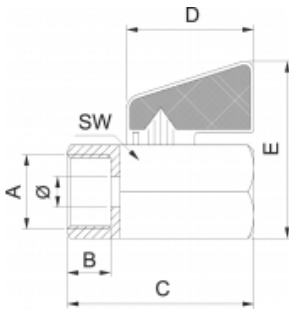

| Ø    | A     | B  | C  | D  | E  | SW | €/St | Bestell-Nr. |
|------|-------|----|----|----|----|----|------|-------------|
| 8,0  | G 1/8 | 9  | 39 | 30 | 38 | 21 | 3,53 | 71.100.518  |
| 8,0  | G 1/4 | 9  | 39 | 30 | 30 | 21 | 3,53 | 71.100.514  |
| 8,0  | G 3/8 | 10 | 41 | 30 | 38 | 21 | 3,53 | 71.100.538  |
| 10,0 | G 1/2 | 12 | 48 | 30 | 42 | 25 | 4,02 | 71.100.512  |
| 14,0 | G 3/4 | 15 | 54 | 30 | 47 | 30 | 6,13 | 71.100.534  |



### Mini - Kugelhahn

#### Mini ball-valve

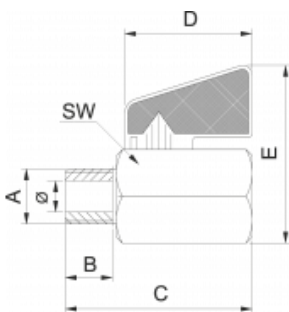

| Ø    | A     | B  | C  | D  | E  | SW | €/St | Bestell-Nr. |
|------|-------|----|----|----|----|----|------|-------------|
| 8,0  | G 1/8 | 9  | 39 | 30 | 38 | 21 | 3,53 | 71.101.518  |
| 8,0  | G 1/4 | 9  | 39 | 30 | 38 | 21 | 3,53 | 71.101.514  |
| 8,0  | G 3/8 | 10 | 40 | 30 | 38 | 21 | 4,48 | 71.101.538  |
| 10,0 | G 1/2 | 12 | 46 | 30 | 42 | 25 | 4,02 | 71.101.512  |
| 14,0 | G 3/4 | 15 | 54 | 30 | 47 | 30 | 6,13 | 71.101.534  |



### Mini - Kugelhahn

#### Mini ball - valve

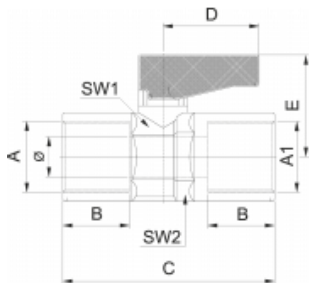

| Ø    | A     | A 1   | B    | C  | D  | E    | SW1 | SW2 | €/St | Bestell-Nr. |
|------|-------|-------|------|----|----|------|-----|-----|------|-------------|
| 5,5  | G 1/8 | G 1/8 | 7,4  | 36 | 19 | 21,0 | 14  | 15  | 5,40 | 71.105.518  |
| 5,5  | G 1/4 | G 1/4 | 11,0 | 43 | 19 | 21,0 | 14  | 15  | 5,57 | 71.105.514  |
| 8,0  | G 3/8 | G 3/8 | 11,4 | 47 | 19 | 22,0 | 18  | 19  | 5,79 | 71.105.538  |
| 10,0 | G 1/2 | G 1/2 | 15,0 | 59 | 26 | 30,5 | 22  | 23  | 7,42 | 71.105.512  |
| 14,0 | G 3/4 | G 3/4 | 16,3 | 67 | 26 | 33,0 | 28  | 30  | 9,68 | 71.105.534  |



### Mini - Kugelhahn

#### Mini ball-valve

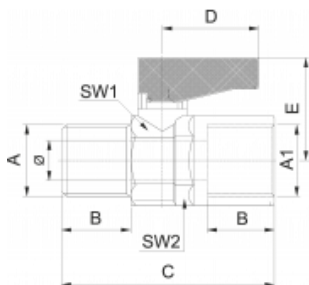

| Ø    | A     | A 1   | B        | C    | D  | E    | SW1 | SW2 | €/St | Bestell-Nr. |
|------|-------|-------|----------|------|----|------|-----|-----|------|-------------|
| 5,5  | G 1/8 | G 1/8 | 7,4      | 36,0 | 19 | 21,0 | 14  | 15  | 5,40 | 71.106.518  |
| 5,5  | G 1/4 | G 1/8 | 11,0/7,4 | 43,0 | 19 | 21,0 | 14  | 15  | 5,57 | 71.106.514  |
| 5,5  | G 1/4 | G 1/4 | 11,0     | 43,0 | 19 | 21,0 | 14  | 15  | 5,57 | 71.106.544  |
| 8,0  | G 3/8 | G 3/8 | 11,4     | 46,0 | 19 | 22,0 | 18  | 19  | 5,79 | 71.106.538  |
| 10,0 | G 1/2 | G 1/2 | 15,0     | 57,0 | 26 | 30,5 | 22  | 23  | 7,42 | 71.106.512  |
| 14,0 | G 3/4 | G 3/4 | 16,3     | 63,0 | 26 | 33,0 | 28  | 30  | 9,68 | 71.106.534  |



### Verteilerleiste

#### Distributor-block

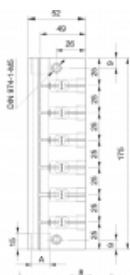

| A          | B          | €/St   | Bestell-Nr. |
|------------|------------|--------|-------------|
| G 3/8 (2x) | G 1/4 (6x) | 163,16 | 71.102.514  |



# KUGELHÄHNE - MESSING VERNICKELT

## Ball valve - brass nickel plated

### Kugelhahn

#### Ball-valve



| A        | ØB    | C   | D   | E   | SW | DN | €/St   | Bestell-Nr. |
|----------|-------|-----|-----|-----|----|----|--------|-------------|
| Rp 1/4   | 25,5  | 51  | 80  | 40  | 18 | 10 | 4,97   | 71.103.514  |
| Rp 3/8   | 25,5  | 60  | 80  | 40  | 21 | 10 | 5,30   | 71.103.538  |
| Rp 1/2   | 32,5  | 75  | 89  | 50  | 25 | 15 | 6,75   | 71.103.512  |
| Rp 3/4   | 42,0  | 80  | 113 | 59  | 31 | 20 | 10,28  | 71.103.534  |
| Rp 1     | 49,5  | 90  | 113 | 63  | 38 | 25 | 14,99  | 71.103.510  |
| Rp 1 1/4 | 59,5  | 110 | 138 | 77  | 48 | 32 | 24,42  | 71.103.541  |
| Rp 1 1/2 | 72,0  | 120 | 158 | 91  | 54 | 40 | 34,27  | 71.103.521  |
| Rp 2     | 86,0  | 140 | 158 | 97  | 67 | 50 | 48,11  | 71.103.520  |
| Rp 2 1/2 | 122,0 | 147 | 247 | 122 | 86 | 65 | 124,08 | 71.103.522  |

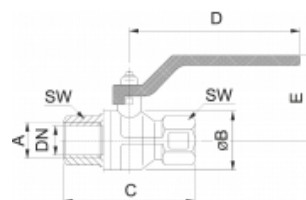

### Kugelhahn

#### Ball-valve



| A       | ØB   | C   | D   | E  | SW | DN | €/St  | Bestell-Nr. |
|---------|------|-----|-----|----|----|----|-------|-------------|
| R 1/4   | 25,5 | 58  | 80  | 40 | 18 | 10 | 5,23  | 71.104.514  |
| R 3/8   | 25,5 | 63  | 80  | 40 | 21 | 10 | 5,46  | 71.104.538  |
| R 1/2   | 32,5 | 77  | 89  | 50 | 25 | 15 | 6,92  | 71.104.512  |
| R 3/4   | 42,0 | 84  | 113 | 59 | 31 | 20 | 10,61 | 71.104.534  |
| R1      | 49,5 | 92  | 113 | 63 | 38 | 25 | 15,16 | 71.104.510  |
| R 1 1/4 | 59,5 | 110 | 138 | 77 | 48 | 32 | 24,35 | 71.104.541  |
| R 1 1/2 | 72,0 | 121 | 158 | 91 | 54 | 40 | 35,72 | 71.104.521  |
| R 2     | 86,0 | 141 | 158 | 97 | 67 | 50 | 48,34 | 71.104.520  |

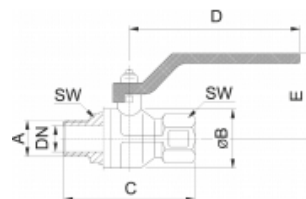

### Kugelhahn mit DVGW- Zulassung

#### DVGW ball valve



| A        | ØB   | C   | D   | E  | SW | DN | €/St  | Bestell-Nr. |
|----------|------|-----|-----|----|----|----|-------|-------------|
| Rp 1/4   | 25,5 | 51  | 80  | 40 | 18 | 10 | 5,30  | 71.108.514  |
| Rp 3/8   | 25,5 | 60  | 80  | 40 | 21 | 10 | 5,54  | 71.108.538  |
| Rp 1/2   | 32,0 | 75  | 89  | 50 | 25 | 15 | 7,16  | 71.108.512  |
| Rp 3/4   | 42,0 | 80  | 113 | 59 | 31 | 20 | 10,84 | 71.108.534  |
| Rp 1     | 49,5 | 90  | 113 | 63 | 38 | 25 | 13,46 | 71.108.510  |
| Rp 1 1/4 | 59,5 | 110 | 138 | 77 | 48 | 32 | 24,58 | 71.108.525  |
| Rp 1 1/2 | 72,0 | 120 | 158 | 91 | 54 | 40 | 34,83 | 71.108.550  |
| Rp 2     | 86,0 | 140 | 158 | 97 | 67 | 50 | 41,39 | 71.108.520  |

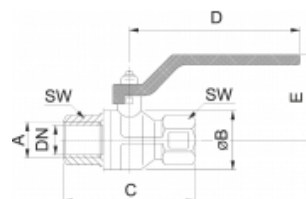

# KUGELHÄHNE - MESSING VERNICKELT

## Ball valve - brass nickel plated

### Kugelhahn mit Entlüftung

#### Exhaust ball valve

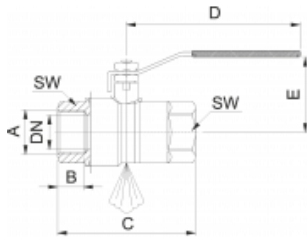

| A     | B  | C  | D   | E  | SW | DN | €/St  | Bestell-Nr. |
|-------|----|----|-----|----|----|----|-------|-------------|
| G 1/4 | 10 | 45 | 96  | 47 | 20 | 8  | 14,60 | 71.109.514  |
| G 3/8 | 10 | 45 | 96  | 47 | 20 | 10 | 14,60 | 71.109.538  |
| G 1/2 | 14 | 59 | 96  | 52 | 25 | 15 | 16,38 | 71.109.512  |
| G 3/4 | 15 | 64 | 116 | 59 | 31 | 20 | 22,19 | 71.109.534  |
| G1    | 20 | 81 | 116 | 63 | 40 | 25 | 33,95 | 71.109.510  |



### L-Bohrung, allseits abgedichtet

#### 3-way ball valve, L-configuration

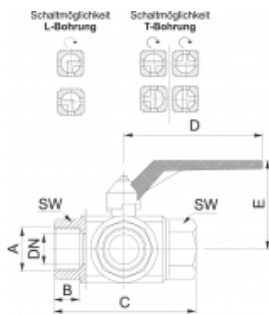

| A      | B  | C   | D   | E   | SW | DN | €/St   | Bestell-Nr. |
|--------|----|-----|-----|-----|----|----|--------|-------------|
| G 1/4  | 19 | 77  | 125 | 85  | 22 | 10 | 34,53  | 71.112.514  |
| G 3/8  | 19 | 77  | 125 | 85  | 22 | 12 | 34,53  | 71.112.538  |
| G 1/2  | 19 | 77  | 125 | 85  | 27 | 14 | 34,53  | 71.112.512  |
| G 3/4  | 23 | 92  | 145 | 107 | 34 | 18 | 53,91  | 71.112.534  |
| G1     | 25 | 104 | 170 | 125 | 41 | 23 | 76,32  | 71.112.510  |
| G1 1/4 | 27 | 118 | 170 | 129 | 50 | 29 | 107,66 | 71.112.541  |
| G1 1/2 | 31 | 138 | 170 | 148 | 57 | 36 | 160,37 | 71.112.521  |
| G2     | 36 | 162 | 260 | 182 | 70 | 45 | 252,71 | 71.112.520  |



### T-Bohrung, allseits abgedichtet

#### 3-way ball valve, T-configuration

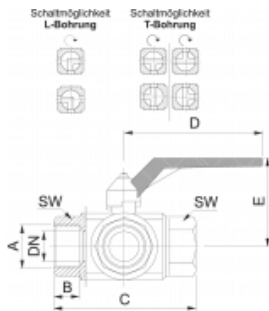

| A      | B  | C   | D   | E   | SW | DN | €/St   | Bestell-Nr. |
|--------|----|-----|-----|-----|----|----|--------|-------------|
| G 1/4  | 19 | 77  | 125 | 85  | 22 | 10 | 34,53  | 71.113.514  |
| G 3/8  | 19 | 77  | 125 | 85  | 22 | 12 | 34,53  | 71.113.538  |
| G 1/2  | 19 | 77  | 125 | 85  | 27 | 14 | 34,53  | 71.113.512  |
| G 3/4  | 23 | 92  | 145 | 107 | 34 | 18 | 53,91  | 71.113.534  |
| G1     | 25 | 104 | 170 | 125 | 41 | 23 | 76,32  | 71.113.510  |
| G1 1/4 | 27 | 118 | 170 | 129 | 50 | 29 | 107,66 | 71.113.541  |
| G1 1/2 | 31 | 138 | 170 | 148 | 57 | 36 | 160,37 | 71.113.521  |
| G2     | 36 | 162 | 260 | 182 | 70 | 45 | 252,71 | 71.113.520  |



**Sperrventil - pneumatisch gesteuert, doppelwirkend**

**Pneumatic operated blocking valve double effect**



| G      | A     | ØB    | C   | E    | SW | DN | €/St   | Bestell-Nr. |
|--------|-------|-------|-----|------|----|----|--------|-------------|
| G 3/8  | 53,8  | 46,0  | 98  | 30,8 | 22 | 10 | 102,78 | 71.110.538  |
| G 1/2  | 60,0  | 51,7  | 112 | 33,3 | 27 | 15 | 112,89 | 71.110.512  |
| G 3/4  | 70,0  | 63,5  | 135 | 38,3 | 33 | 20 | 128,05 | 71.110.534  |
| G1     | 76,0  | 69,0  | 143 | 41,5 | 41 | 25 | 146,57 | 71.110.510  |
| G1 1/4 | 91,0  | 86,0  | 165 | 48,3 | 50 | 32 | 173,52 | 71.110.511  |
| G1 1/2 | 102,0 | 96,0  | 180 | 53,8 | 60 | 40 | 216,59 | 71.110.550  |
| G2     | 115,0 | 109,0 | 207 | 59,8 | 75 | 50 | 266,18 | 71.110.520  |

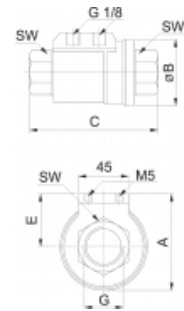

**Sperrventil - pneumatisch gesteuert, einfachwirkend, federschliessend**

**Pneumatic operated blocking valve single effect**



| G      | A     | ØB    | C   | E    | SW | DN | €/St   | Bestell-Nr. |
|--------|-------|-------|-----|------|----|----|--------|-------------|
| G 3/8  | 53,8  | 46,0  | 98  | 30,8 | 22 | 10 | 102,78 | 71.111.538  |
| G 1/2  | 60,0  | 51,7  | 112 | 33,3 | 27 | 15 | 112,89 | 71.111.512  |
| G 3/4  | 70,0  | 63,5  | 135 | 38,3 | 33 | 20 | 128,05 | 71.111.534  |
| G1     | 76,0  | 69,0  | 143 | 41,5 | 41 | 25 | 146,57 | 71.111.510  |
| G1 1/4 | 91,0  | 86,0  | 165 | 48,3 | 50 | 32 | 173,52 | 71.111.525  |
| G1 1/2 | 102,0 | 96,0  | 180 | 53,8 | 60 | 40 | 216,59 | 71.111.550  |
| G2     | 115,0 | 109,0 | 207 | 59,8 | 75 | 50 | 266,18 | 71.111.520  |

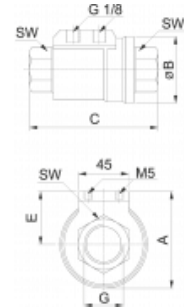

**Kugelhahn mit pneumatischen Stellantrieb doppelwirkend ( einfachwirkend auf Anfrage )**

**Pneumatically operated ball valve**



| G      | ØD    | A     | B    | C   | H     | SW  | €/St   | Bestell-Nr. |
|--------|-------|-------|------|-----|-------|-----|--------|-------------|
| G 3/8  | 31,8  | 70    | 43,2 | 69  | 88,0  | 22  | 151,65 | 71.114.538  |
| G 1/2  | 31,8  | 70,0  | 43,2 | 69  | 88,0  | 28  | 153,32 | 71.114.512  |
| G 3/4  | 40,0  | 114,0 | 48,0 | 77  | 103,5 | 32  | 198,80 | 71.114.534  |
| G1     | 48,0  | 114,0 | 48,0 | 89  | 107,5 | 41  | 210,60 | 71.114.510  |
| G1 1/4 | 60,0  | 130,0 | 55,0 | 103 | 131,0 | 50  | 262,00 | 71.114.525  |
| G1 1/2 | 70,6  | 130,0 | 55,0 | 114 | 138,0 | 55  | 288,42 | 71.114.550  |
| G2     | 86,5  | 144,0 | 60,0 | 134 | 150,7 | 70  | 361,38 | 71.114.520  |
| G2 1/2 | 111,0 | 168,5 | 72,0 | 161 | 180,5 | 87  | 522,28 | 71.114.560  |
| G3     | 136,5 | 184,0 | 80,5 | 185 | 211,0 | 107 | 710,99 | 71.114.530  |

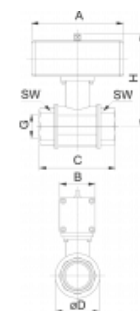

# KUGELHÄHNE - MESSING VERNICKELT

Ball valve - brass nickel plated

**mit L - Bohrung. Pneumatischer Stellantrieb, doppelwirkend ( einfachwirkend auf Anfrage ), allseits abgedichtet**

## L- configuration

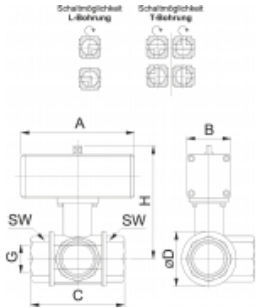

| G      | ØD | A   | B  | C   | E   | H   | DN | €/St   | Bestell-Nr. |
|--------|----|-----|----|-----|-----|-----|----|--------|-------------|
| G 3/8  | 29 | 114 | 48 | 54  | 42  | 107 | 10 | 171,22 | 71.115.538  |
| G 1/2  | 36 | 114 | 48 | 69  | 51  | 107 | 15 | 180,61 | 71.115.512  |
| G 3/4  | 45 | 114 | 48 | 77  | 61  | 121 | 20 | 230,43 | 71.115.534  |
| G1     | 54 | 114 | 48 | 89  | 73  | 121 | 25 | 266,91 | 71.115.510  |
| G1 1/4 | 65 | 140 | 55 | 103 | 87  | 148 | 32 | 353,95 | 71.115.525  |
| G1 1/2 | 79 | 140 | 55 | 114 | 100 | 155 | 40 | 357,32 | 71.115.550  |
| G2     | 96 | 162 | 65 | 134 | 121 | 176 | 50 | 456,39 | 71.115.520  |



**mit T - Bohrung. Pneumatischer Stellantrieb, doppelwirkend ( einfachwirkend auf Anfrage ), allseits abgedichtet**

## T- configuration

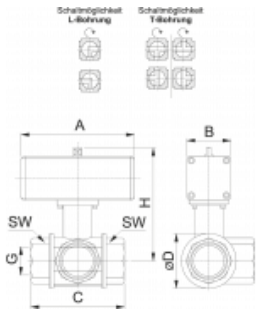

| G      | ØD | A   | B  | C   | E   | H   | DN | €/St   | Bestell-Nr. |
|--------|----|-----|----|-----|-----|-----|----|--------|-------------|
| G 1/2  | 36 | 114 | 48 | 80  | 51  | 112 | 15 | 257,09 | 71.116.512  |
| G 3/4  | 45 | 114 | 48 | 96  | 61  | 131 | 20 | 303,56 | 71.116.534  |
| G1     | 54 | 114 | 48 | 113 | 73  | 135 | 25 | 349,22 | 71.116.510  |
| G1 1/4 | 65 | 140 | 55 | 130 | 87  | 163 | 32 | 445,28 | 71.116.525  |
| G1 1/2 | 79 | 140 | 55 | 147 | 100 | 167 | 40 | 500,31 | 71.116.550  |
| G2     | 96 | 162 | 65 | 169 | 121 | 199 | 50 | 0,00   | 71.116.520  |

